



# RIDE 80XL

*Translation of the original notice*



**URBANGLIDE** is a brand imported by the company PACT INFORMATIQUE,  
located at 33 rue du Ballon – 93160 Noisy Le Grand – France

Urbanglide.fr



Urbanglide



Urbanglide Channel





# SOMMAIRE

**ENGLISH**

**FRENCH**

**SPANISH**

**PORTUGUESE**

## **SAFETY AND PRECAUTION**

Please read the manual carefully before using the product and read the risks and safety tips in the manual. The use of an electrical product can be dangerous if the user is not watchful. Misuse and non-respect with the safety instructions does not affect the company in event of accident. Self-judgment and common sense are necessary for users to detect the possible dangers.

Please verify the current regulations and laws in your country to know where and how to use your product legally. You must comply with the rules and laws that applicable to vehicles and pedestrians.

- **Protective equipment**

Always wear the following protective equipment:

- Approved and certified helmet according to your location
- Knee pads and elbow patches
- Long sleeve t-shirt and long pants
- Gloves
- Shoes with rubber soles, never drive in barefoot or sandal. Verify to make the laces made and keep them as far as possible from the wheels and the internal system.



- **Driver's advice**

This device may be used by children over 8 years of age and by persons with reduced physical, sensory or mental capabilities or lack of experience or knowledge, if properly supervised, or if instructions for use of safely, were given to them and the risks were apprehended. Children under 8 must not play with the product. Cleaning and user maintenance should not be performed by unattended children. Do not touch the engine or the brakes of the product immediately after use, these parts may be extremely hot. The maximum weight of use is 100 kg.

### **Procedures and driving conditions**

Please verify the current laws and rules in your country before using the product. Look around when using the product and pay attention to all possible risks. It is important to respect the rights and properties of everyone. For your safety do not start the accelerator if you are not on the product. This product is not designed to make jumps, acrobatic tricks and skids.

Never drive on roads, near vehicles, stairs, hills, swimming pools or other streams. Please hold the handlebars with both hands. Never go on the product with more than one person. Be sure to keep your fingers and other body parts away from hot parts during use (Brake, motor, chain). Never use the product with a Mp3 player, or with your smartphone at hand.

Never use the product to pull anything, as this may damage the components and wear out the battery. Never put the product in contact with water, the electrical components can be damaged and create a dangerous situation. Roll only on flat and solid surfaces. Avoid surfaces with gravel, holes, ice, which can lead to loss of control of the product. Do not drive at night or in areas where visibility is reduced. Do not ride indoors where there are carpets as they can interfere.

After each use, verify that each piece is in its proper place, and that it is not damaged. Before each use, verify the following points:

- The brakes are in good condition
- All components are in good condition and in their places
- The parts with defects in the last use have been repaired or replaced according to the manufacturer's conditions.

People who have medical follow-up or treatment such as: cardiac people, pregnant women, irresponsible people, people with back or neck problems, should not use the product.

When not using your scooter, use the kickstand to keep it upright. To do this, straighten the metal bar located under the tray of your scooter. You can adjust the height of the handlebar using the buttons on the sleeve. Press the button and pull your handlebars up to raise your handlebars.

- **Usage of the charger**

A plastic cap is located on the loading port of your scooter, remove it to load your product, and do not forget to put it back before using your scooter so as not to damage the loading port. Before using the product, it is necessary to charge it. A long charge may be necessary before the first use. Please refer to the battery indicator, you can charge your battery at any time to ensure the constant power. It is not necessary to wait until the battery is completely empty to charge it. Please do not use the charger of other brand, these can damage the battery of your product. To ensure a normal life cycle, it is important to charge your battery at least once every 3 months, even if you are not using the product. It is imperative to use the supplied charger which is specially designed for this scooter.

Avoid shocks and contact with water, these are factors not covered by the warranty that may damage the battery. The supplied charger is "smart", it will stop at 100% of the charge and not damage the battery. The charger must be in perfect condition during each use, verify the wires, the condition of connection ends and connectors. If the product does not charge, the charger may be defective, it needs to be replaced.

The charger must be used only by an adult, it is important to unplug it from both sides when not charging.

- **Battery**

Please do not store the battery in extreme temperatures. Store it below 30 ° C and above 0 ° C. If you do not use your product for 60-90 days, the battery may get worse. This loss of autonomy is due to lack of use and is therefore not covered by the warranty.

At the end of its cycle, the battery must be discarded separately from the undifferentiated generic waste. Discard the batteries in the containers provided for this purpose. The recovery and recycling of batteries contributes to protect the environment and material resources conservation.

- **Maintenance**

Please store your product in a dry, dust-free place, and avoid leaving it in a humid area or under the sun for too long. To clean your appliance, use a damp cloth and mild detergent. Do not use alcohol, gasoline, kerosene, or other corrosive chemical solvents to clean your appliance, which will damage its appearance and structure.

Constantly verify the condition of components of your product, if any part is damaged, please replace it before using the product. If a part is not working, falling and injuring may occur. Do not disassemble the scooter in case of breakdown, otherwise the warranty will cancel. Before any intervention, it is advisable to turn off your scooter. For all spare parts, please contact your dealer

- **Transport**

If you wish to transport your product by air or other means of transport as well as its battery, please contact the local authorities and the carrier beforehand to obtain the possible prohibitions and limits of transport. Lithium batteries are considered dangerous in many countries. Please make sure that the access and transport are allowed before travelling. International law prohibits the transport of lithium batteries by air.

- **Using the scooter**

To turn on your product, press the Power button, then press the accelerator to advance. To move forward, place both feet on the board, and use the right trigger on your handlebars to advance your scooter. To brake, you can use the left trigger on your handlebar, or press the rear fender with your foot to reduce the speed of your scooter. Before each use, please check that the wheels are not clogged, that the brakes are working and that no warning message is displayed. Using the scooter for long periods can cause vibrations that can be unpleasant, make poses regularly.

- **Rebus**

THIS TROTTINETTE CONTAINS LITHIUM BATTERIES THAT MUST BE RECYCLED SAFELY. Recycling: The battery must be removed before being discarded. Before any work, remember to turn it off and unplug it from the power outlet.

## Product presentation and description

It possesses an elegant design, it is easy to control and eco-friendly.





- 1- Thumb Accelerator
- 2- Thumb electronic Magnetic Brake
- 3- Horn Button
- 4- Setting Button
- 5- Switch Button
- 6- Light Button
- 7- LCD Display
- 8- Speed level

## **Instructions for use**

### a) **On/Off**

Press the switch to turn on the device (5). To turn it off press 3 seconds. The scooter will turn off after 3 minutes if it is not used.

### b) **Speed control**

Press the accelerator (1) to control the speed. There are 3 levels of speed, press the speed button to change level (8).

### c) **Brake control**

Press the brake (2).

### d) **Horn**

To operate the horn, the unit must be turned on. Then press the horn (3).

### e) **LED headlight**

Press the light button (6), a light will be displayed to indicate that the light is on. To turn it off, press the light button again.

## **Adjust handlebar size**

1. Open the lock lever in the direction of the arrow (a).
2. Press the button (b) while pressing the handlebar (c) and push the lock lever to the lock position.

## Fold the product

3. Hold the handlebars with both hands, and press the push buttons (1-d). Extract the handlebar handles (2-d) as far as possible and fold down.
4. Push the handlebar forward (e), step with the foot on the folding lever in the direction of the arrow (f).
5. Continue bending the scooter until the folding hook reaches and locks the bolt on the rear brake.

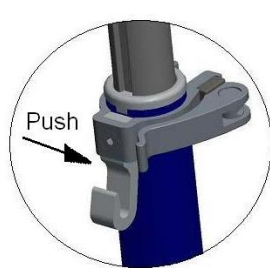

a

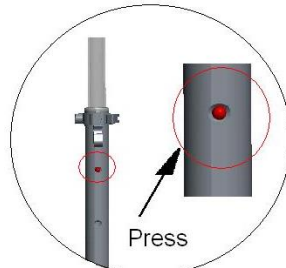

b

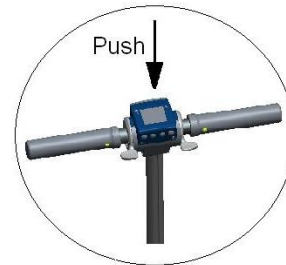

c

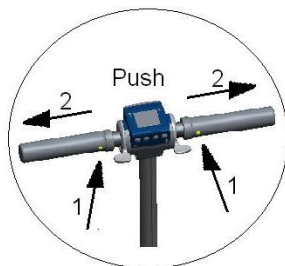

d

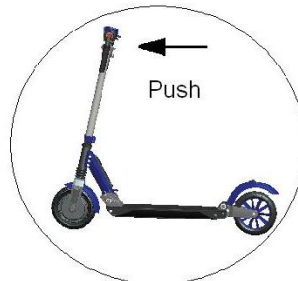

e

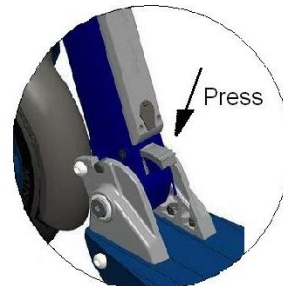

f





## Unfold the product

1. Press the brake in the direction of the arrow (**a**) until the locking hook releases the bolt on the rear brake. Then lift the handlebar until reaching the working position and lock button is set up (**b**).
2. Raise both handlebar grips until they automatically return to their original position (**c**).
3. Push the lock lever in the direction of the arrow (**d**) and raise the handlebar to the desired height. Then press the button (**e**) and fix it in one of the two holes.

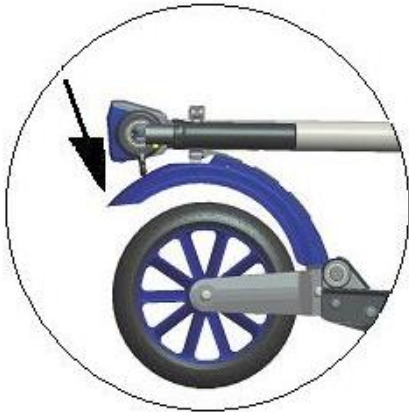

**a**

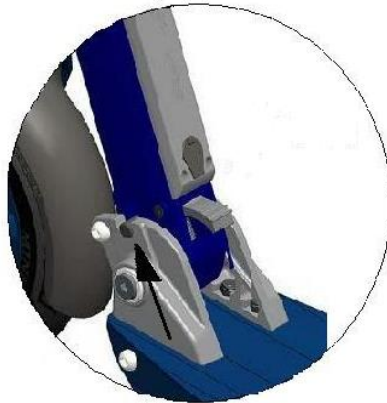

**b**



**c**

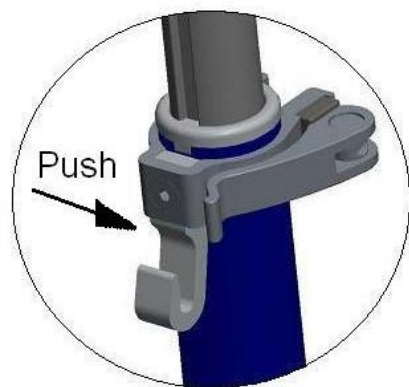

**d**

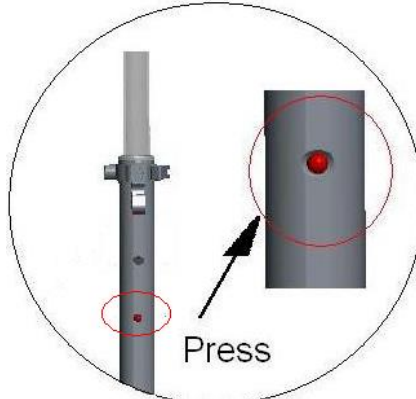

**e**

## How to use

1. Choose a suitable place to ride.
2. Open the scooter as previously indicated.
3. Adjust the height of the handlebar according to your height.
4. Press the switch to turn on the scooter.
5. Put one foot on the scooter and leave the other foot on the ground.
6. Gently press the accelerator, place the foot on the floor, on the scooter. Press harder on the accelerator to increase the speed.
7. To brake, simply press the front brake on the left side of the handlebar. Press harder on the brake to slow down faster.

**Warning !** The rear brake is not to use if you ride at full speed, it may damage the wheel.



## Load the product

1. Make sure the charging connector is clean and dry.
2. Start by plugging the switch into the power interface, and then plug the other end of the charger into the Segway.
3. When the red indicator lights up on the charger, it means charging is successful, if not, check that the line is connected properly.
4. When the LED on the charger changes from red to green, the battery is fully charged. Stop loading. Charge time too long could affect the life of the battery.

## TROUBLESHOOTING

<b>Problem</b>	<b>Possible cause</b>	<b>Solution</b>
<b>It does not work</b>	The battery is not charged.	Charge the battery, check if the red light is on.
	Connections or cables are disconnected.	Check that the battery is firmly seated in the product.
<b>It does not work continuously</b>	The battery needs to be charged.	Charge the battery, check if the red light is on.
	The battery is not fully charged.	Make sure the power cable is well connected. The battery may need to be replaced.
<b>It suddenly stopped working</b>	Overload, cut-off	Overloading may result in product failure. Turn off the product, wait 15 seconds, then turn it on again.
	Fuse burnt	Overloading can burn fuses, you may have to replace them. For this, contact the after-sales service. Prior to this, check the condition of all cables and connectors.
<b>It is moving slowly</b>	The brakes are not properly adjusted.	Check the condition of the brakes, and try to loosen. If this does not work, please contact the after-sales service.
	It has overloaded	Check that the user weighs less than the previously recommended weight. Check that there are no objects obstructing the proper operation of the product.
	Bad driving condition.	Make sure you are on flat, dry, and constant ground.
	The tires / wheels are damaged.	Check the condition of the wheels of the product.

## DECLARATION OF CONFORMITY

We undersigned PACT INFORMATIQUE hereby declare that the product.

**Model :** URBANGLIDE 80XL

**Type:** Electric scooter

**Function:** Scooter for individual transport

**Product description:** Foldable electric scooter with indicator and adjustable handlebar.

Meets all standards and technical directives below:

### DIRECTIVES

2014/30/EU	2011/65/EU	(EU) 2015/863	2006/42/EC
------------	------------	---------------	------------

### TESTS STANDARD

IEC 62321-4:2013+A1:2017	IEC 62321-6:2015	EN ISO 12100:2010
IEC 62321-7-1:2015	IEC 60335-1	EN ISO 12100:2010
IEC 62321-7-2:2017	IEC62133B	EN ISO 12100A
IEC 62321-3-1:2013	IEC 62133	EN 62233:2008
IEC 62321-1:2013	EN 60335-1:2012+A11:2014	ISO 17075-1:2017
IEC 62321-2:2013	EN 61000-6-3:2007+A1:2011	
IEC 62321-5:2013	EN 61000-6-1:2007	

### CERTIFICATES/REPORTS

SZEM180700605901	GZHL1707031762SP	GEZS170721217702
SZEM1807006059IT	GZES1707012177MDC	GZES170721217703
SZEM1807006059ITV	GZES170701217701	IEC 62133:2012
SZES170700286601	GZES170701217702	
SZXEC1800319501	GZES170701217703	

All radio emission tests were carried out by the laboratories mentioned below:

**SGS-CSTC Sandards Technical Servicies (Shanghai) Co.,Ltd.**

588 West Jindu Road, Xinqiao, songjiang, 201612 Shanghai, China

### Contact details of the manufacturer or agent:

PACT Informatique  
33 rue du ballon  
93160 Noisy le Grand – France

### Contact details of the person authorized to edit the technical document:

Michael Barreira  
33 rue du ballon  
93160 Noisy le Grand - France

This declaration shall be issued under the responsibility of the manufacturer and, where appropriate, of his representative

09/09/2019



### Representative of the company:

PACT INFORMATIQUE  
33 rue du ballon – Noisy le Grand - France  
Maurice Bodokh  
CEO